



6020-Z Deep groove ball bearings

- SKF Explorer

Deep groove ball bearings

Bearing data

[Tolerances](#),

Normal (metric), P6, P5, Normal (inch),

[Radial internal clearance](#),

Matched bearing pairs, Stainless steel
 $d < 10$ mm, Other bearings

Bearing interfaces

[Seat tolerances for standard conditions](#),

[Tolerances and resultant fits](#)

Technical specification

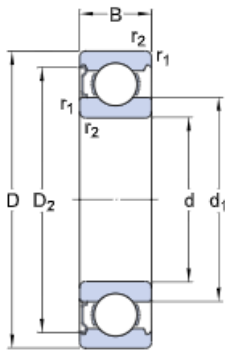

DIMENSIONS

d	100 mm	Bore diameter
D	150 mm	Outside diameter
B	24 mm	Width
d_1	≈ 115.95 mm	Shoulder diameter
D_2	≈ 138.3 mm	Recess diameter
$r_{1,2}$	min. 1.5 mm	Chamfer dimension

ABUTMENT DIMENSIONS

d_c min.	107 mm	Diameter of shaft abutment
d_c max.	115.9 mm	Diameter of shaft abutment
D_c max.	143 mm	Diameter of housing abutment
r_a max.	1.5 mm	Radius of shaft or housing fillet

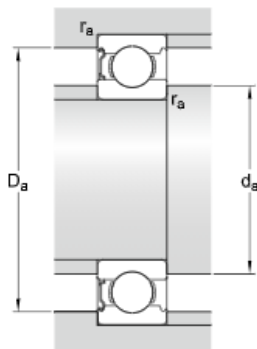

CALCULATION DATA

C	63.7 kN	Basic dynamic load rating
C ₀	54 kN	Basic static load rating
P _u	2.04 kN	Fatigue load limit
	9 500 r/min	Reference speed
	5 600 r/min	Limiting speed
k _r	0.025	Minimum load factor
f ₀	15.9	Calculation factor

MASS

	1.28 kg	Mass bearing
--	---------	--------------

TOLERANCE CLASS

P6	Dimensional tolerances
Normal	Radial run-out